

Stone Saws TITAN - CLASSIC - INTERCRAFT Security Advices, Machine Care and Cleaning

SECURITY ADVICES

The TITAN, CLASSIC and INTERCRAFT stone saws are strictly to be used with diamond cutting blades only. They are designed for cutting stone and ceramic materials only. No metal or wood cutting blades shall be installed and started up. Water tubs and diamond cutting blades have to be checked for wear regularly. Electrical cables have to be placed in specified mountings and have to be checked regularly. The electrical system has to be tested by a professional electrician once a year. Electrical and technical changes are to be made only by a qualified technician.



Attention! Always wear safety goggles, ear protection, protective mask and safety gloves.

If the saw is equipped with a laser: Don't look into the laser steam.

MACHINE CARE

1. Check before use if the blades of the pump (3) turn easily.
2. Check cutting head (4) for play on the guide rail.
If there is too much play, adjust the cutting head (see page 2)
3. Cleaning of the machine is recommended daily. (see page 2)
Attention! Do not use hot steam cleaner or high pressure cleaner.
4. Clean guide rail (2) regularly with a dry cleaning cloth.
Attention! Do not use oil or grease on guide rails.
5. Move the universal angle (5) regularly for continuous smooth operation. Grease spring and ball occasionally.
6. If you use the mitre cut only occasionally, it is advisable to move it all 2 - 3 weeks with the crank wheel (1) for 3 - 4 times up and down for continuous smooth operation.

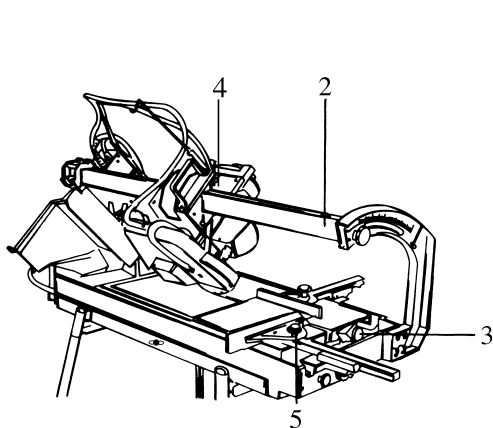

Intercraft / Classic

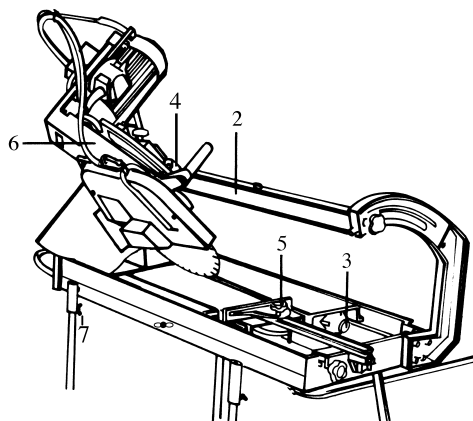

Titan

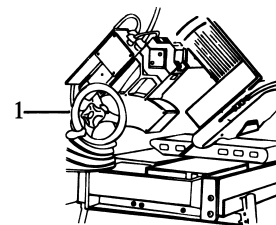

CHECKING OF CUTTING HEAD

In case your cutting head got a play by transport or any other agitation you can easily repair it. Remove the bearing cover (part no. 36), loosen the screws (part no. 14a) and clamp the bearing blocks (part no. 14) with two screw clamps until you notice that there is no more play. Check this on the whole guide rail by moving the cutting head to and fro. Make sure that all bearings are turning freely. Tighten the screws (part no. 14a) again. After reattachment of the bearing cover (part no. 36) you can make a fine adjustment with the two adjustment screws (part no. 36a). Now the machine shall be fully functionally again.

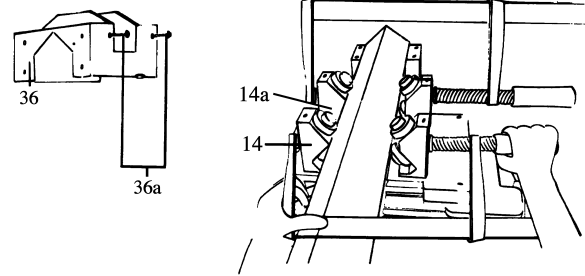

CLEANING OF THE SAW

Clean guide rail regularly with a dry cleaning cloth.
Attention! Do not use oil or grease on guide rails.

Drain dirty water from the tub daily to prevent a plugging of the water pump. For draining the dirty water lift the table out of the tub and open the drain plug (1).

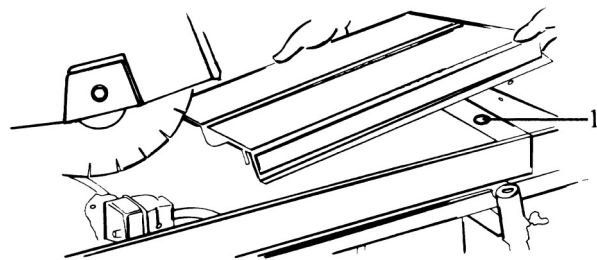

Clean rubber pads on work table well to keep them non-skid.

Attention! Do not use hot steam cleaner or high pressure cleaner.

V-BELT - INSTALLATION AND MAINTENANCE specially for the model TITAN

It is particularly important that the belt pulleys are parallel to each other.

The v-belt should be free of grease and dirt.

Misaligned and dirty v-belts will lower their life span.

Installation of the v-belt should be free and easy by hand. For this the distance of the axes has to be reduced accordingly.

It is important that the tension of the v-belt is set as per measurements shown in the drawing.

After a short initial running the v-belt tension should be rechecked and if necessary be readjusted as per specifications.

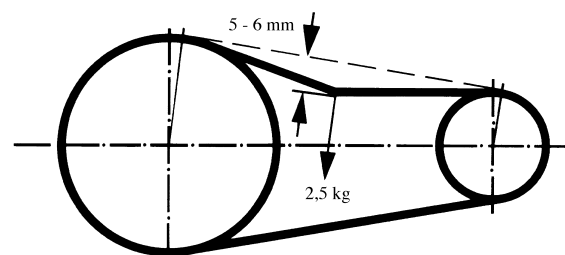

Checking of the v-belt tension:
At a pressure of 2,5 kg
the sag should be 5 - 6 mm.